

# FITTING GUIDE

## TOWER CABINET

HEIGHT: 84 - 96"  
 WIDTH: 12" - 36"  
 DEPTH: 13 1/2" - 25"

### FI.PK.FIT.006 - TOWER 1

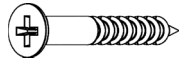

(H) x8 1 1/4" Screws



(B) x28 5/8" Screws



(K) x2 L Bracket - Large



Screws for attaching to walls are not provided as these vary depending on wall material and construction. Ensure appropriate fixings for wall construction are used.

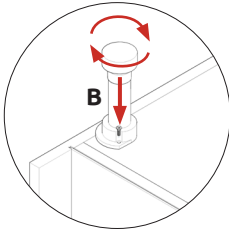

#### Step 1.

Secure each leg into place with 2 x 5/8" screws (B). Ensure legs are rotated as shown so that end panel is supported.

**It is important to lift the cabinet onto its legs, Do Not Tilt as depicted on the right.**

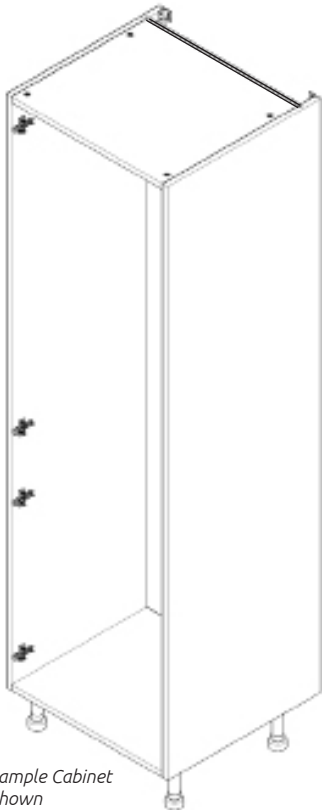

Sample Cabinet Shown

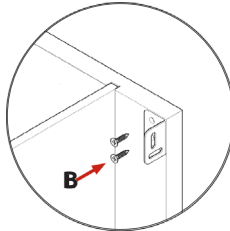

#### Step 2.

Use 2 x 5/8" screws (B) to attach each of the L brackets (K) to the top of the cabinet on the left and right sides. The remaining positions on the L bracket are to be used to secure the cabinet to the wall.

**Screws for attaching to the wall are not supplied as these vary depending on your wall material and construction. Ensure appropriate fixings for wall construction are used.**

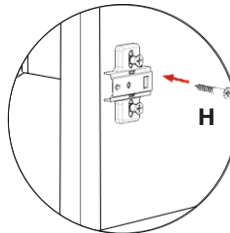

Sample Hinge Shown

#### Step 3.

Screw into any adjacent cabinets using 1 1/4" screws (H) provided to secure the cabinet. Screw just to the rear of the hinge plate and to the rear of the cabinet at the top and bottom. Place a cover cap on the head to conceal it.

