

# FITTING GUIDE

## Corner Post

CURVED  
SQUARE  
PILASTER

## FI.PK.FIT.011 - CURVED/SQUARE CNR POST OR PILASTER ACCESSORIES

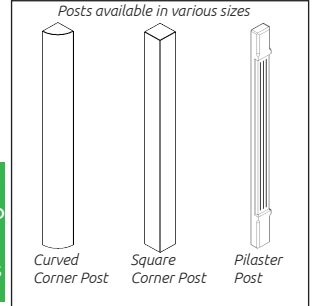
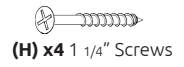

### Step 1.

Scribe/cut the back of the decor end panel to the wall.  
If the height requires cutting/scribing ensure it is done on the top edge.

**Include the size of the post in your measurements so that it aligns with the frontals.**

**When cutting the decor end panel a table or circular saw is recommended**

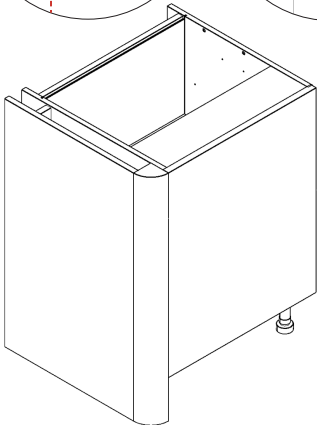
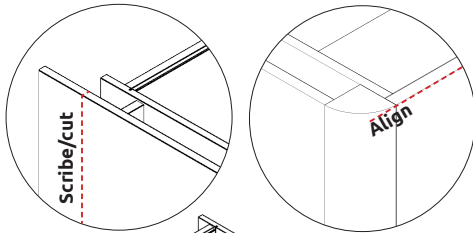

Base installation shown for illustration purposes.

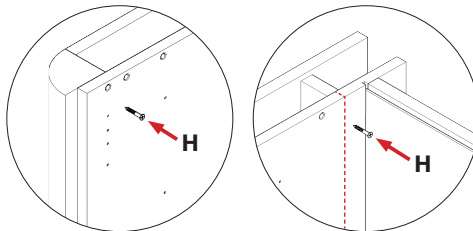

### BEFORE YOU START

INSTALLATION SHOULD BE PERFORMED BY A COMPETENT PERSON ONLY.

THIS PRODUCT COULD BE DANGEROUS IF INCORRECTLY INSTALLED.

### Step 2.

If required, cut the post from the top to the required height.  
**See customer kitchen plan for reference**

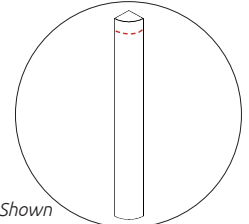

### Step 3.

Fit 4 x L brackets SML (J) on the front edge of the decor end panel and then attach to the post using the 5/8" screws (B) provided.  
**Ensure decor end panel sits flush with post.**

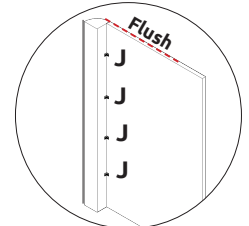

### Step 4.

Fix filler panel to rear of decor end panel using 4 x L brackets SML (J) and the 5/8" screws (B) provided.

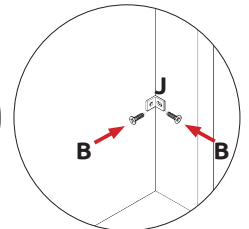
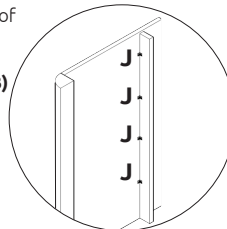

### Step 5.

Attach the assembled decor end panel to the carcass with 2 x 1 3/4" screws (H) from inside of the unit, through to the post. Then use 2 x 1 3/4" screws (H) from inside of the unit, through to the filler panel.  
**The screws should be equally spaced and positioned so they are least visible.**

### REQUIRED TOOLS

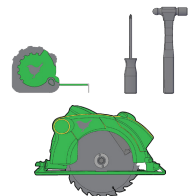

**wren**  
KITCHENS