

FITTING GUIDE

Base Cabinet

HEIGHT: 19 1/2" - 34 1/2"
WIDTH: 6" - 30"
DEPTH: 13 1/2" - 25"

FI.PK.FIT.001 - BASE

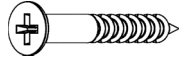

(H) x8 1 1/4" Screws

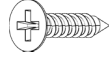

(B) x32 5/8" Screws



x4 (K) L Bracket - Large



Screws for attaching to walls and worktop are not provided as these vary depending on materials, thickness and construction. Ensure appropriate fixings for wall and worktop construction are used. Please refer to the specialist worktop supplier if these are required for solid surface worktops.

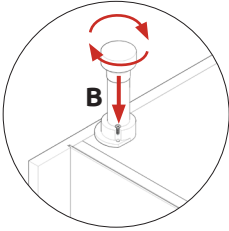

Step 1.

Secure each leg into place with 2 x 5/8" screws (B). Ensure legs are rotated as shown so that end panel is supported.

Sample Cabinet Shown

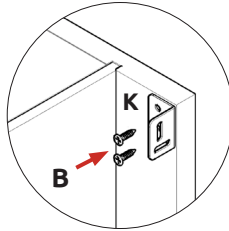
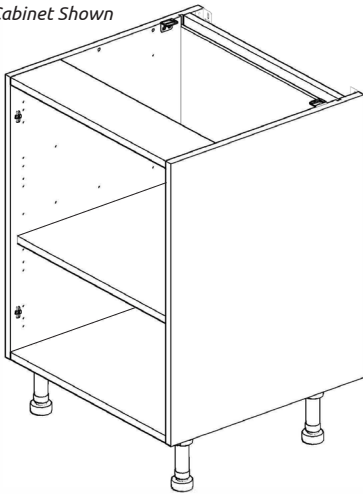

Step 2.

Use 2 x 5/8" screws (B) to attach each of the L brackets (K) to the top of the cabinet on the left and right sides. The remaining positions on the L bracket are to be used to secure the cabinet to the wall. **Screws for attaching to the wall are not supplied as these vary depending on your wall material and construction. Ensure appropriate fixings for wall construction are used.**

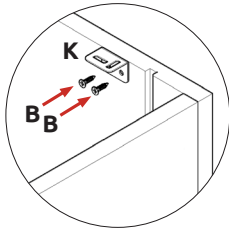

Step 3.

Use 2 x 5/8" screws (B) to secure each of the L brackets (K) to the cabinet at either side. Then screw up and into the worktop as shown.

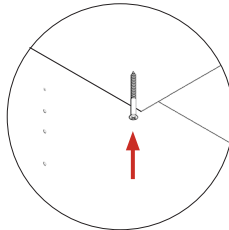

Step 4.

Screw up through the front rail into your worktop to secure it in place.

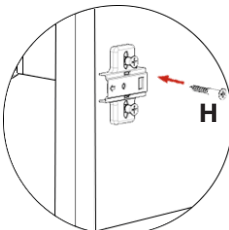

Step 5.

Screw into any adjacent cabinets using 1 1/4" screws (H) provided to secure the cabinet. Screw just to the rear of the hinge plate and to the rear of the cabinet at the top and bottom. Place a cover cap on the head to conceal it.

Sample Hinge Shown

REQUIRED TOOLS



wren
KITCHENS